

ACOUSTIC PENDANT LIGHT INSTALLATION GUIDE

- DOME

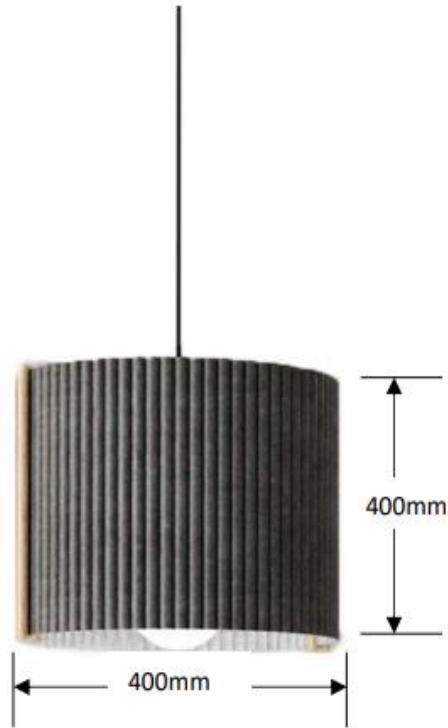

ACCESSORIES DETAIL

1. Fittings



Top cover + screw & nut

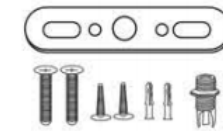

Bracket holder + screw & nut



Hook



Bulb Holder



Lamp cover

2. Optional for plastered ceiling; to use reinforcement on top of the ceiling



Spring toggle

or



Plywood Strip (9 – 15mm thk)



INSTALLATION METHOD

1. Drill two holes on the ceiling based on the desired position. Fasten two expansion screws to the ceiling.

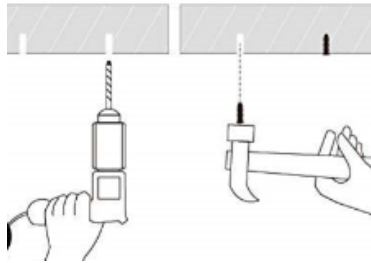

2. Attach two flat-head screw on the mounting bracket and fix the mounting bracket to surface using two tapping screw provided.

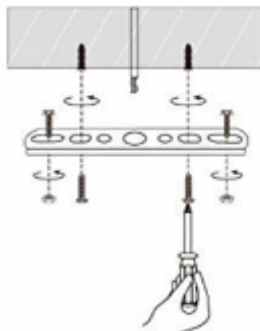

PI

3. Screw the top cover with fittings provided.

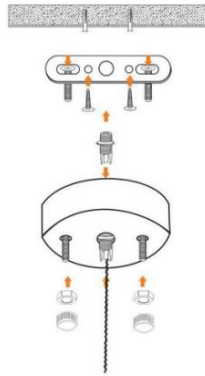

4. Connect the earth wire and power cable using the terminal blocks.

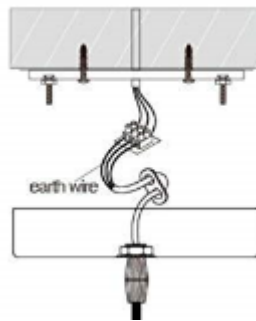

5. Fix the ceiling base plate to hanging panel using two nuts provided.



6. Screw the hook on top cover and insert the electrical wire.

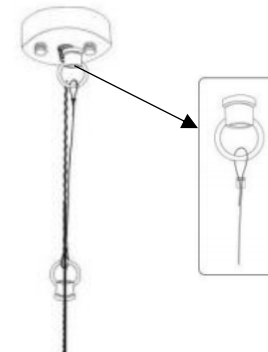

7. Insert the lamp cover followed by the bulb and finish it by attaching the laser cut cover.



7. Tips ; standard height to hang the pendant light

